

Shaft Operator WA 400

As a frame-mounted operator

Shaft operator WA 400 for all track applications, except for L, LD, HU, RD, RG, VU and WG

As shown in the figure, the operator can be fitted either left or right, viewed from the inside.

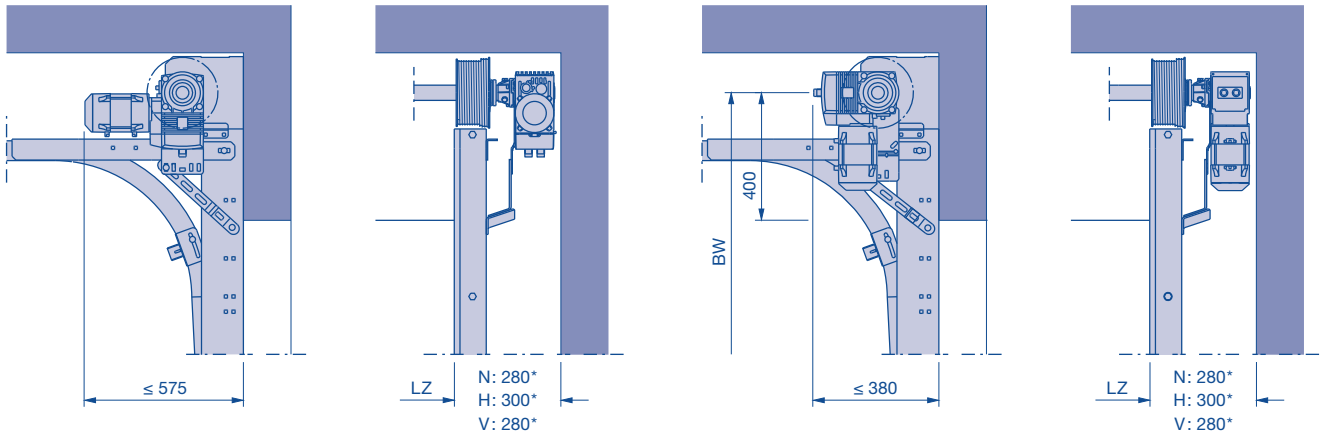

*** Note:**

Dimension + 75 mm if using a non-jointed emergency crank handle

Shaft operator WA 400 for track applications HU, RD, RG, VU and WG

As shown in the figure, the operator can be fitted either left or right, viewed from the inside.

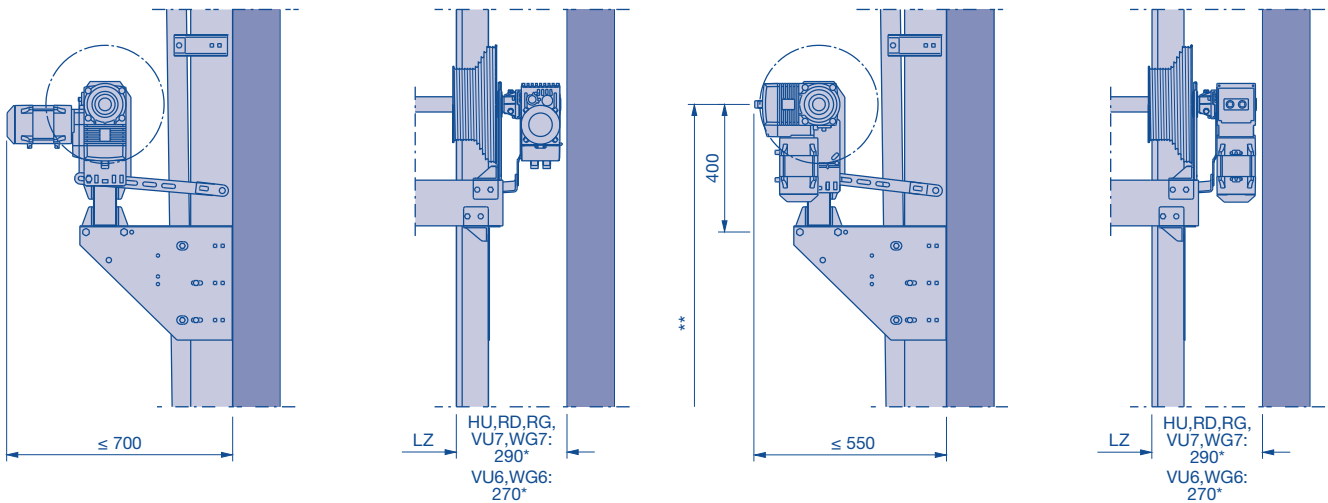

*** Note:**

Dimension + 75 mm if using a non-jointed emergency crank handle

** On request

LZ Clear frame dimensions
BW Position of shaft support

Shaft Operator WA 400

With chain box

Shaft operator WA 400 for all track applications, except for L, LD, HU, RD, RG, VU and WG

As shown in the figure, the operator can be fitted either left or right, viewed from the inside.

In fitting example 5: on the side opposite the door lock.

Fitting example ⑤ right

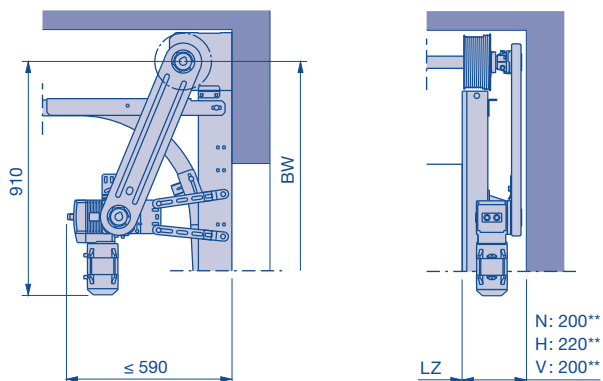

Fitting example ⑥ right

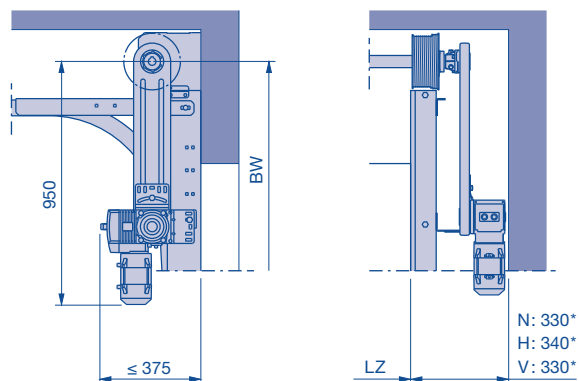

Shaft operator WA 400 for the track applications L and LD

As shown in the figure, the operator can be fitted either left or right, viewed from the inside.

In fitting example 5: on the side opposite the door lock.

Fitting example ⑤ right

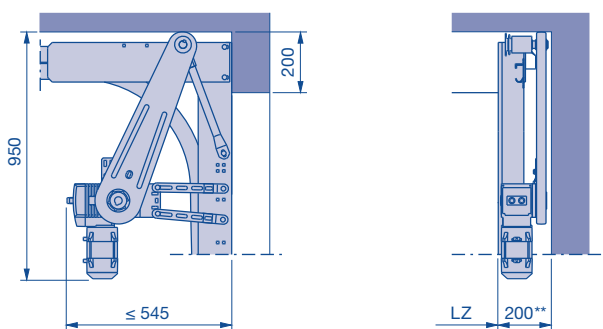

Fitting example ⑥ right

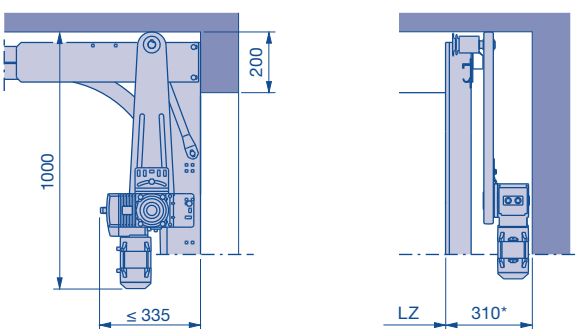

Shaft operator WA 400 for track applications HU, RD, RG, VU and WG

As shown in the figure, the operator can be fitted either left or right, viewed from the inside.

In fitting example 5: on the side opposite the door lock.

Fitting example ⑤ right

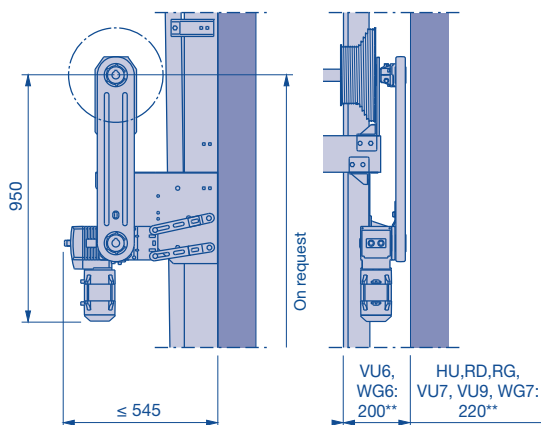

Fitting example ⑥ right

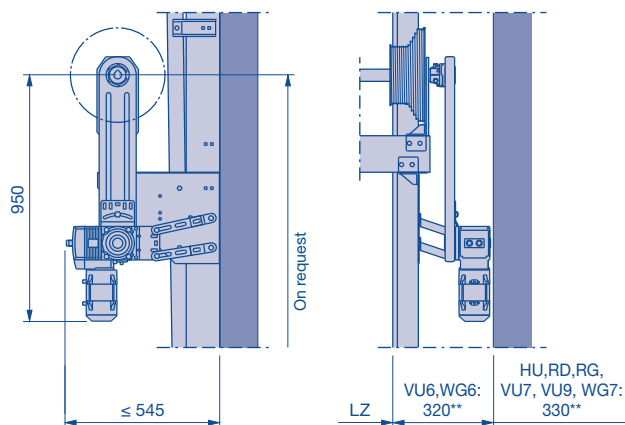

*** Note:**

Dimension + 75 mm if using a non-jointed emergency crank handle

LZ Clear frame dimensions

**** Note:**

Dimension + 40 mm if using a non-jointed emergency crank handle

BW Position of shaft support

Shaft Operator WA 400

For central mounting

Shaft operator WA 400 for track applications N and ND

Control A / B 445, 460

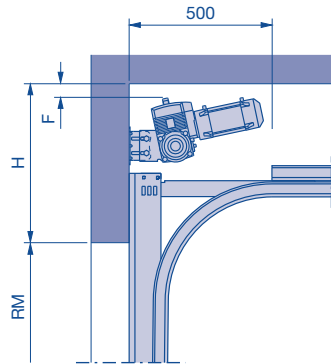

Track application	A / B 445, 460		B 460 FU	
	H min.	F min.	H min.	F min.
N 1	520	45	590	45
N 2	550	50	615	45
N 3	-	-	675	45
ND 1	520	65	550	48
ND 2	550	75	570	48
ND 3	-	-	650	48

Control B 460 FU

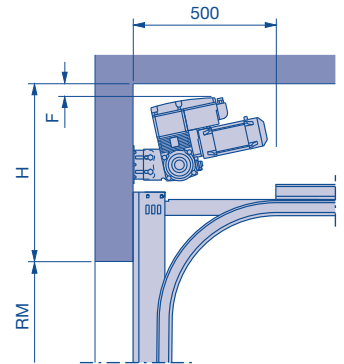

Shaft operator WA 400 for the track applications NH and GD

Control A / B 445, 460

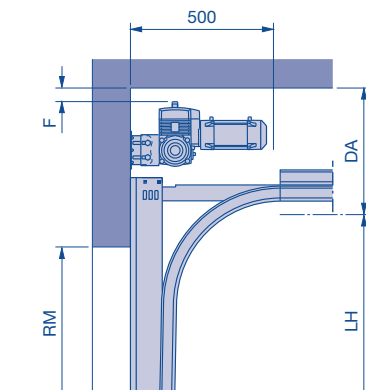

Track application	A / B 445, 460		B 460 FU	
	DA min.	F min.	DA min.	F min.
NH 1 / GD 1	415	50	480	45
NH 2 / GD 2	440	50	485	45
NH 3	-	-	565	45

Control B 460 FU

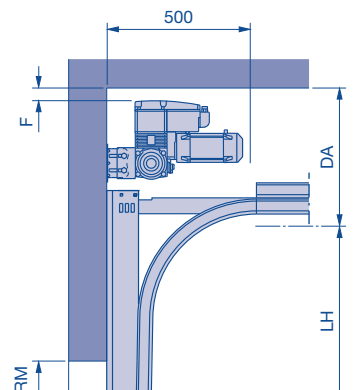

Shaft operator WA 400 for track application NS

Control A / B 445, 460

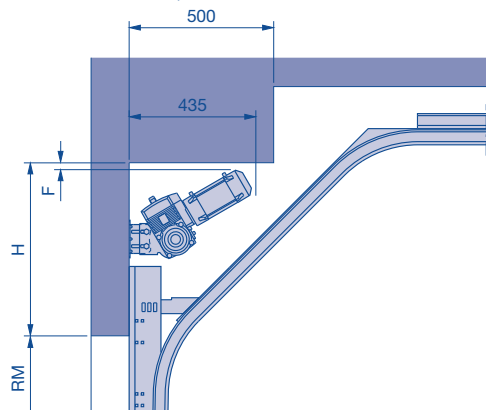

Control B 460 FU

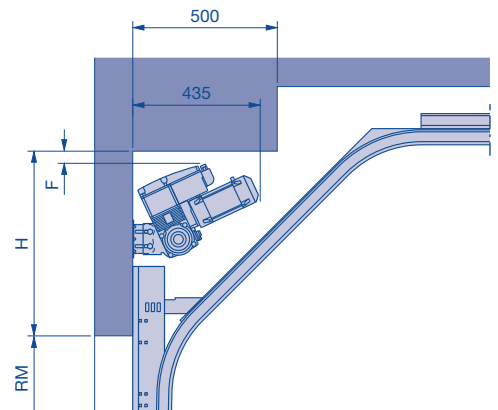

Track application	A / B 445, 460		B 460 FU	
	H min.	F min.	H min.	F min.
NS 1	570	20	615	45
NS 2	600	25	640	45

Note:

WA 400 as a centre motor in conjunction with double spring shaft on request!

H Headroom
RM Grid height

DA Distance to ceiling
LH Track height

F Clearance ceiling / shaft operator

Shaft Operator WA 400

For central mounting

Shaft operator WA 400 for track applications H, HG and HD

Control A / B 445, 460

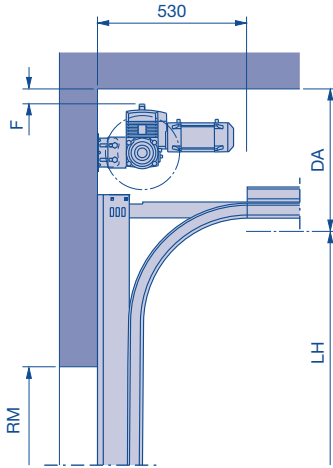

Control B 460 FU

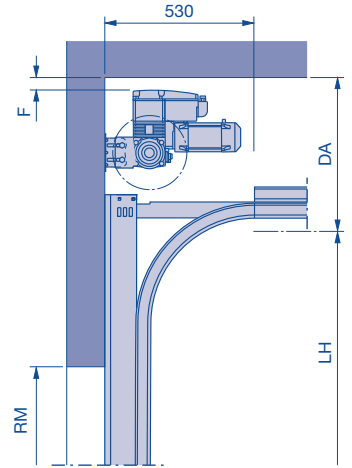

Track application	A / B 445, 460		B 460 FU	
	DA min.	F min.	DA min.	F min.
H 4, HG 4	500	55	540	45
H 5, HG 5	500	55	540	45
H 8	-	-	565	45
HD	On request			

Shaft operator WA 400 for the track applications HU, RD and RG

Control A / B 445, 460

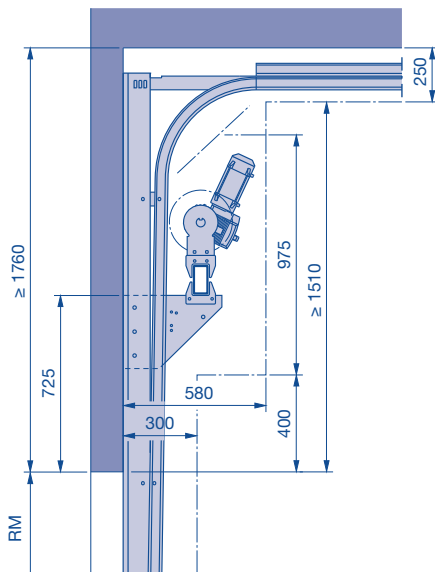

Control B 460 FU

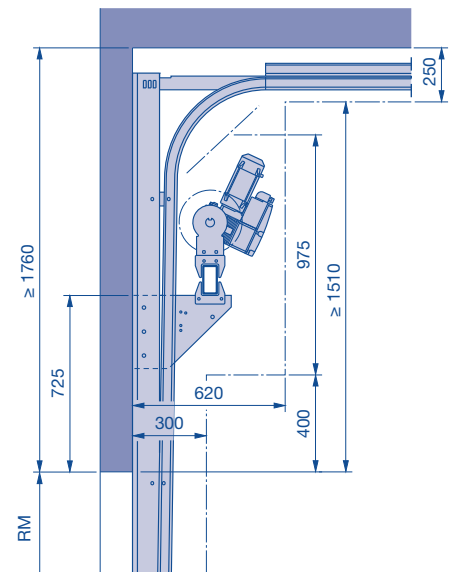

Note:

WA 400 as a centre motor in conjunction with double spring shaft on request!

RM Grid height
DA Distance to ceiling

LH Track height
F Clearance ceiling / shaft operator

Shaft Operator WA 400

For central mounting

Shaft operator WA 400 for track application V

Control A / B 445, 460

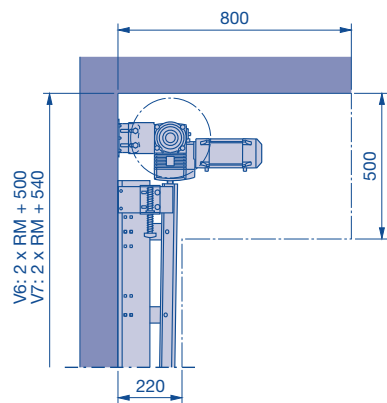

Control B 460 FU

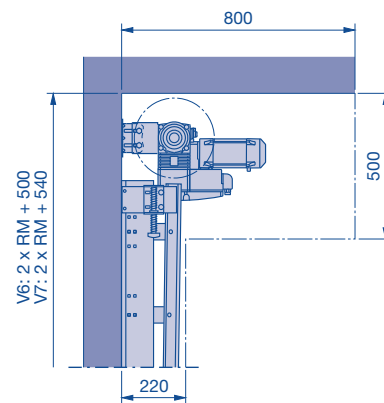

Shaft operator WA 400 for track applications VU and WG

Control A / B 445, 460

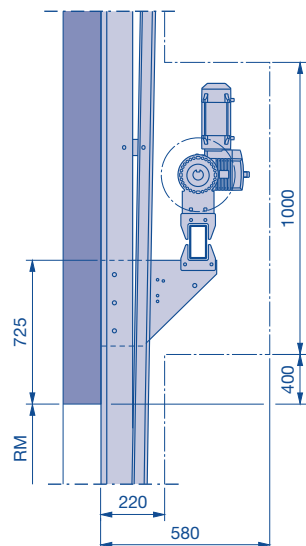

Control B 460 FU

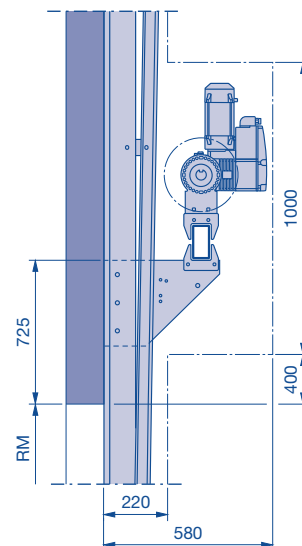

Note:

WA 400 as a centre motor in conjunction with double spring shaft on request!

RM Grid height
DA Distance to ceiling

LH Track height